

*202.001 **MANDOLINE**

EXPLODED VIEW - SPARE PART LIST

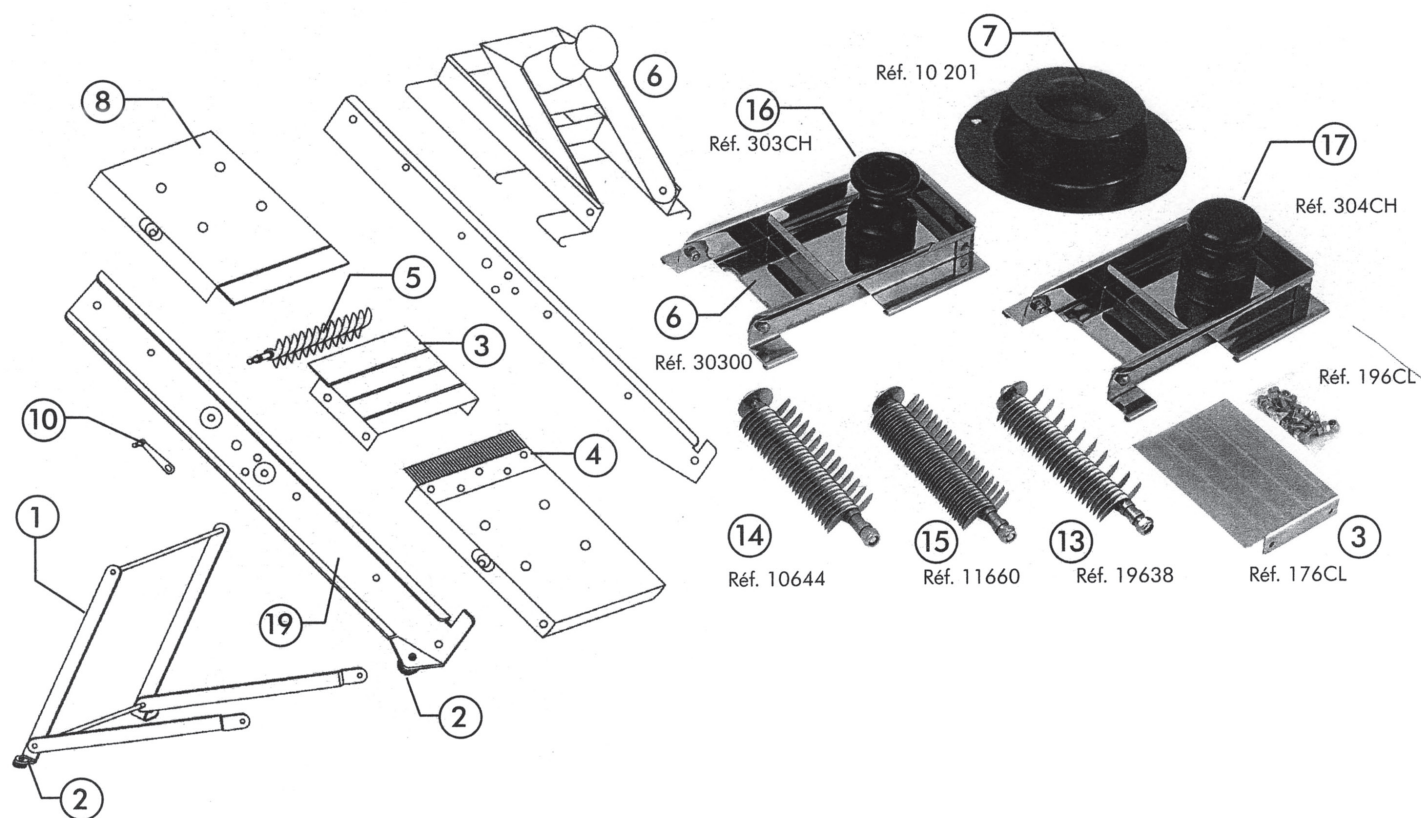

NO	CODE	DESCRIPTION	Q'TY
4	Ref. 126CL	Fluted cutting plate	
18	Ref. 136CL	Simple side	
19	Ref. 137CL	Handle side	
8	Ref. 146CL	Main plate	
1	Ref. 166CL	Folding stand	
3	Ref. 176CL	Straight blade	
10	Ref. 183CL	Crank handle	
2	Ref. 190CL	Nonskid foot	
	Ref. 196CL	Set of screws	
13	Ref. 19638	Set of cutters 38 blades (3/8" and 1/8")	
14	Ref. 10644	Set of cutters 44 blades (1/4" and 1/8")	
15	Ref. 11660	Set of cutters 60 blades (3/16" and 1/12")	
16	Ref. 303CH	Plastic handle for stainless steel guard	
17	Ref. 304CH	Wooden handle for stainless steel guard	
6	Ref. 30300	Stainless steel guard	
7	Ref. 10201	Polycarbonate hand guard	