

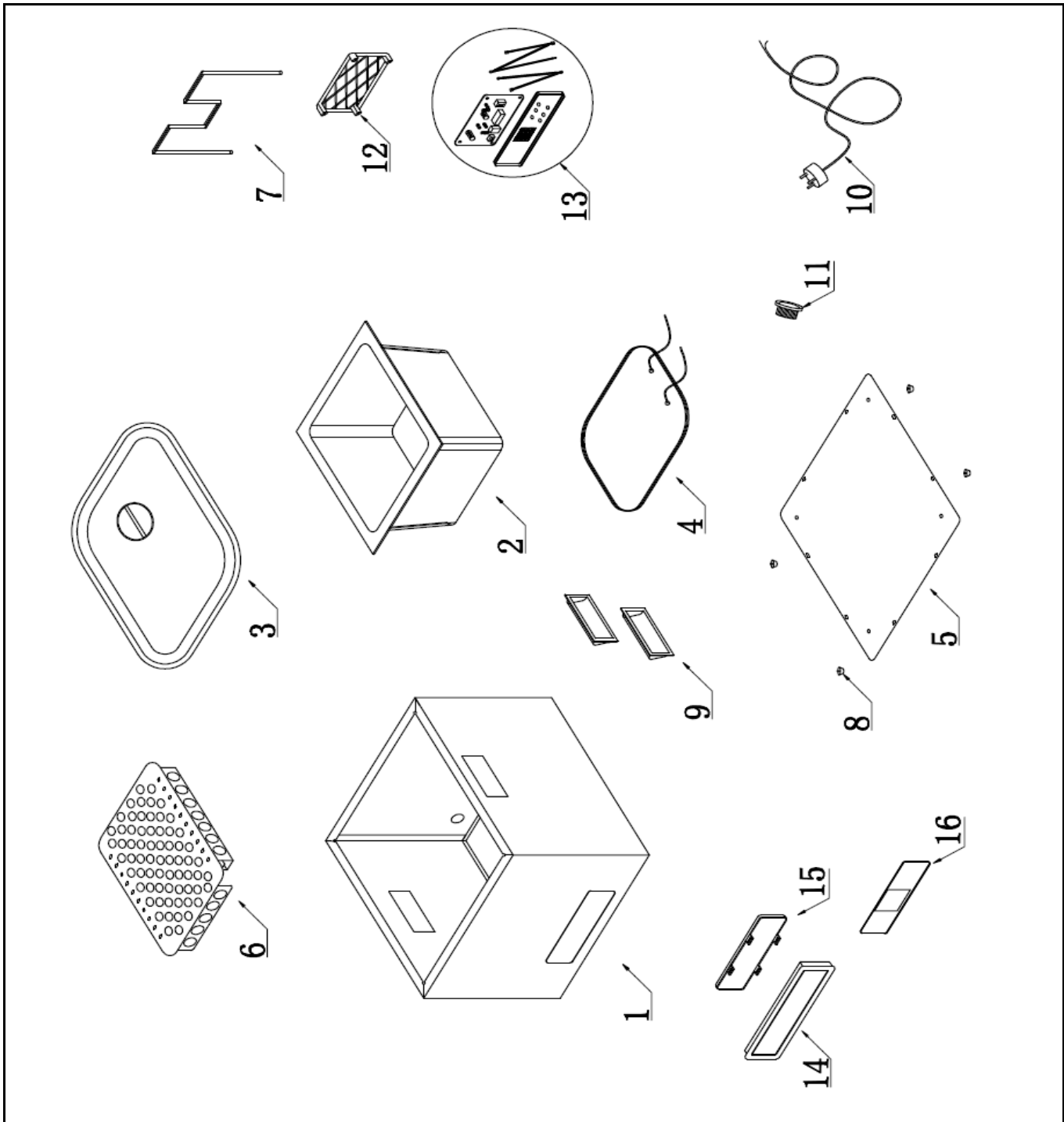

Drawing

 <b>HENDI</b> FOOD SERVICE EQUIPMENT  <b>Hendi B.V.</b> Steenoven 21 3911 TX Rhenen The Netherlands	Batch #	Appliance part#
	HK663067 and up	<b>225264</b>
	Description	
	Sous-vide System GN 2/3	

Date	05-01-2018	Revision #	Revision version 1.2
Revision	New model, new main/display pcb.		



**Bill of materials (BOM)**

 <b>HENDI</b> FOOD SERVICE EQUIPMENT  <b>Hendi B.V.</b> Steenoven 21 3911 TX Rhenen The Netherlands	<b>Batch #</b>	<b>Appliance part#</b>
	HK663067 and up	<b>225264</b>
	<b>Description</b>	
<b>Sous-vide System GN 2/3</b>		

<b>Date</b>	05-01-2018	<b>Revision #</b>	Revision version 1.2
<b>Revision</b>	New model, new main/display pcb.		

Item	Description	Part#	Quantity	Remark	Picture
1	Housing	n/a	1		
2	Bin incl. element	n/a	1		
3	Lid GN2/3 with silicone rim	804018	1		
4	Element	n/a	1		
5	Bottom cover	n/a	1		
6	Bottom grid plate	935330	1	Incl. 4 pcs bow grid 931059	
7	Bow grid	931059	4		
8	Feet	943649	4		
9	Handle	943618	2		
10	Power cord 3x1.0mm <sup>2</sup> (C13) EU plug	943625	1		
11	Panel mount (C14) plug	943632	1		
12	Holder main pcb	943588	1		
13	Main/display pcb complete set	943595	1	Incl probe.	
14	Display box	n/a	1		
15	Cover display box	943601	1		
16	Glass display box	n/a	1		

n/a -> not available

nss -> not sold separately

### Wiring diagram

 <b style="font-size: 24px; font-weight: bold; color: red;">HENDI</b> <small>FOOD SERVICE EQUIPMENT</small>  <b>Hendi B.V.</b> Steenoven 21 3911 TX Rhenen The Netherlands	<b>Batch #</b>	<b>Appliance part#</b>
	HK663067 and up	225264
	<b>Description</b>	
	Sous-vide System GN 2/3	

<b>Date</b>	05-01-2018	<b>Revision #</b>	Revision version 1.2
<b>Revision</b>	New model, new main/display pcb.		

